

# Project Information



**KINGDOM**  
Housing Association



**Cupar Road, Bonnybank Phase 2**

# BACKGROUND - Cupar Road, Bonnybank Phase 2

This development is located in the small village of Bonnybank in the Levenmouth area of Fife, around 2 miles north of Leven.

The project provided 14 new homes for social rent which were bought off the shelf from Larkfleet Homes. It was the second phase of the neighbouring development which was also purchased by Kingdom, bringing the total number of units to 25.

Along with semi detached general needs houses, cottage flats and amenity bungalows were also provided. The new homes provide residents with energy efficient homes which meet Housing for Varying Needs and the Association's own design standards. The project has achieved Building Controls Full Bronze and Silver Aspects 1 & 2 Standard of sustainability through the installation of Photovoltaic Panels on all properties.

The properties are owned and managed by Kingdom Housing Association.



**Landlord**  
**Kingdom Housing Association**





# Funding & Costs

Total Project Funding £2,149,800

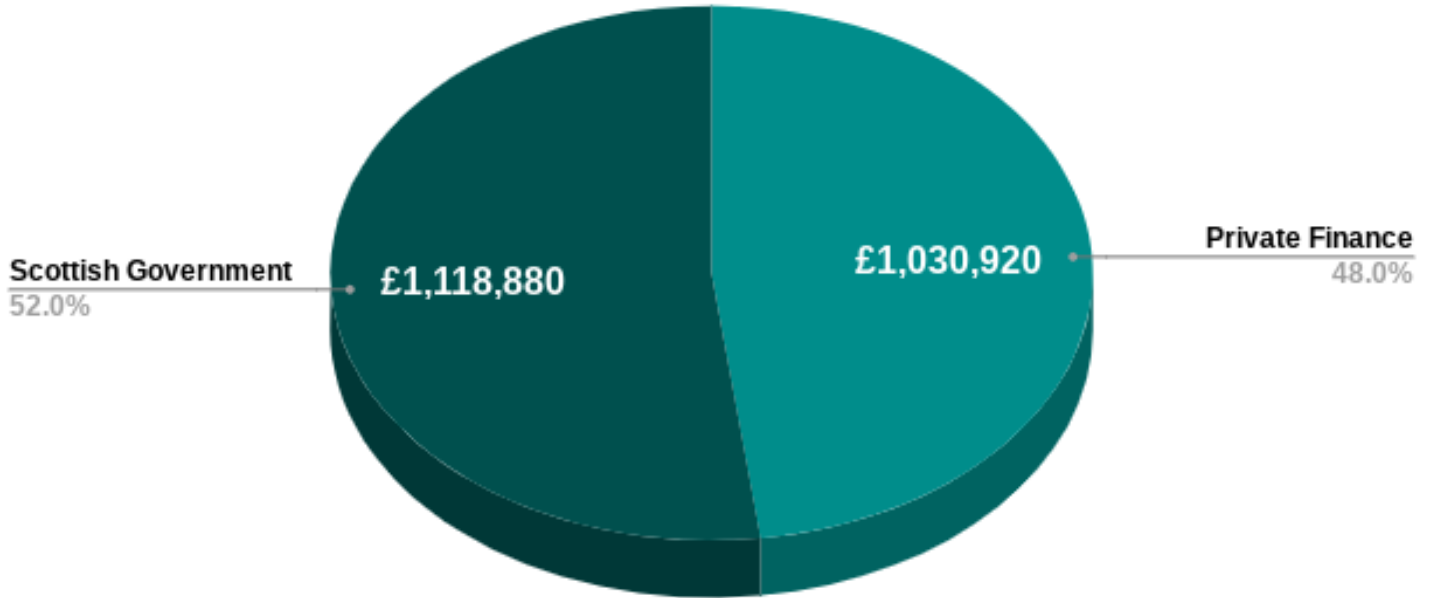

Units: 14 Social Rent	Per Unit	Total
Scottish Government Funding	£79,920	£1,118,880
Private Finance	£73,637	£1,030,920
Project Costs	£153,557	£2,149,800
Works Costs	£150,000	£2,100,000
Rents at First Allocation	£374 - £467 pcm.	



## Site Layout of Phase 2 - As Proposed

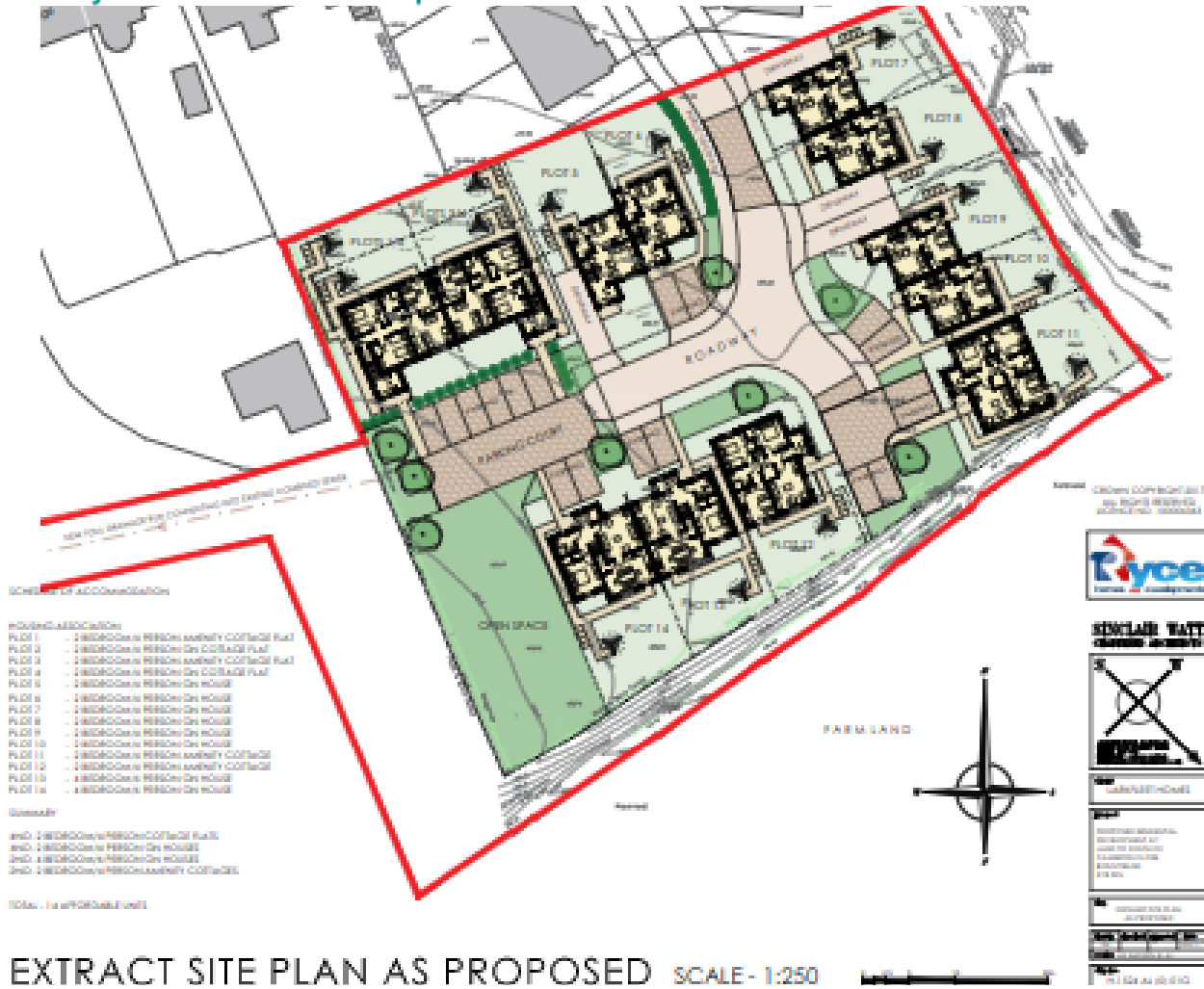

EXTRACT SITE PLAN AS PROPOSED SCALE - 1:250

### Points to Note:

- Building Control’s Bronze with Silver Aspects 1 & 2 Standard of **Sustainability** has been achieved.
- An **Energy Rating** of B (81-91) has been achieved.
- **Photovoltaic Panels** have been installed on all properties.
- Amenity Bungalows have been fitted with **Wet Floor Showers**.

<b>Construction Period</b>	<b>June 2020 - September 2021</b>
<b>Contract Type</b>	<b>Off the Shelf</b>
<b>Contractor</b>	<b>Larkfleet Homes</b>
<b>Architect</b>	<b>Contractor Appointed</b>
<b>Employers Agent</b>	<b>N/A</b>
<b>Principal Designer</b>	<b>Contractor Appointed</b>
<b>Engineer</b>	<b>Contractor Appointed</b>

